

CURLLEW

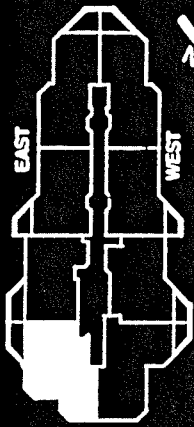

The living/dining area lends itself to many interesting furniture settings. The third bedroom is versatile too. It could be a study/den, or a sewing room. From the fully equipped kitchen you can see through glass doors to the large terrace with its rousing sunrise view.

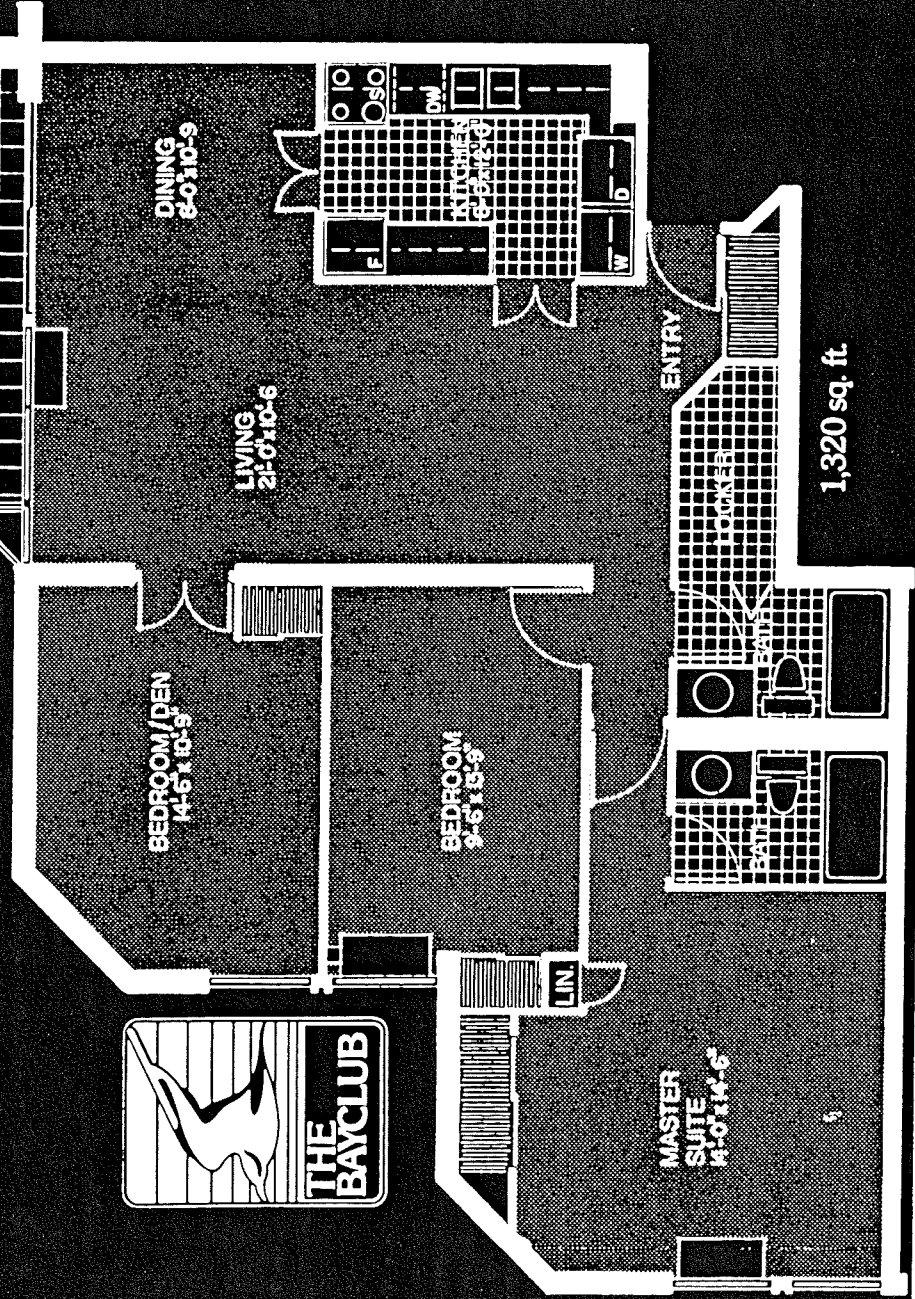

1,320 sq. ft.

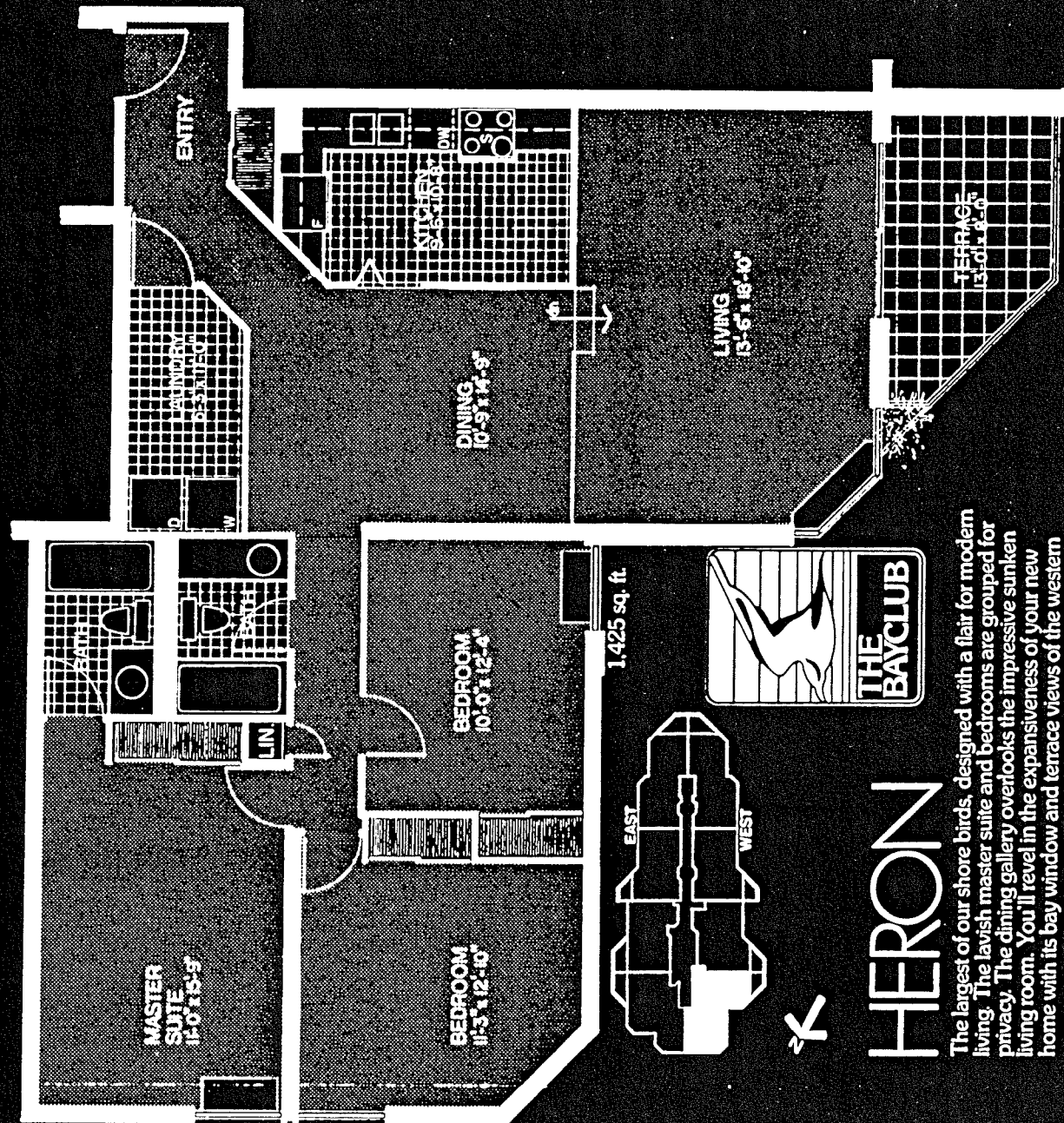

HERON

The largest of our shore birds, designed with a flair for modern living. The lavish master suite and bedrooms are grouped for privacy. The dining gallery overlooks the impressive sunken living room. You'll revel in the expansiveness of your new home with its bay window and terrace views of the western panorama.

KINGFISHER

Your home for a carefree lifestyle. A dramatic arrangement of elegant room space. Superior convenience features include a large separate laundry centre. The immense daily living area offers flexibility and awaits your personal touch. The rising sun will greet you on the commodious terrace.

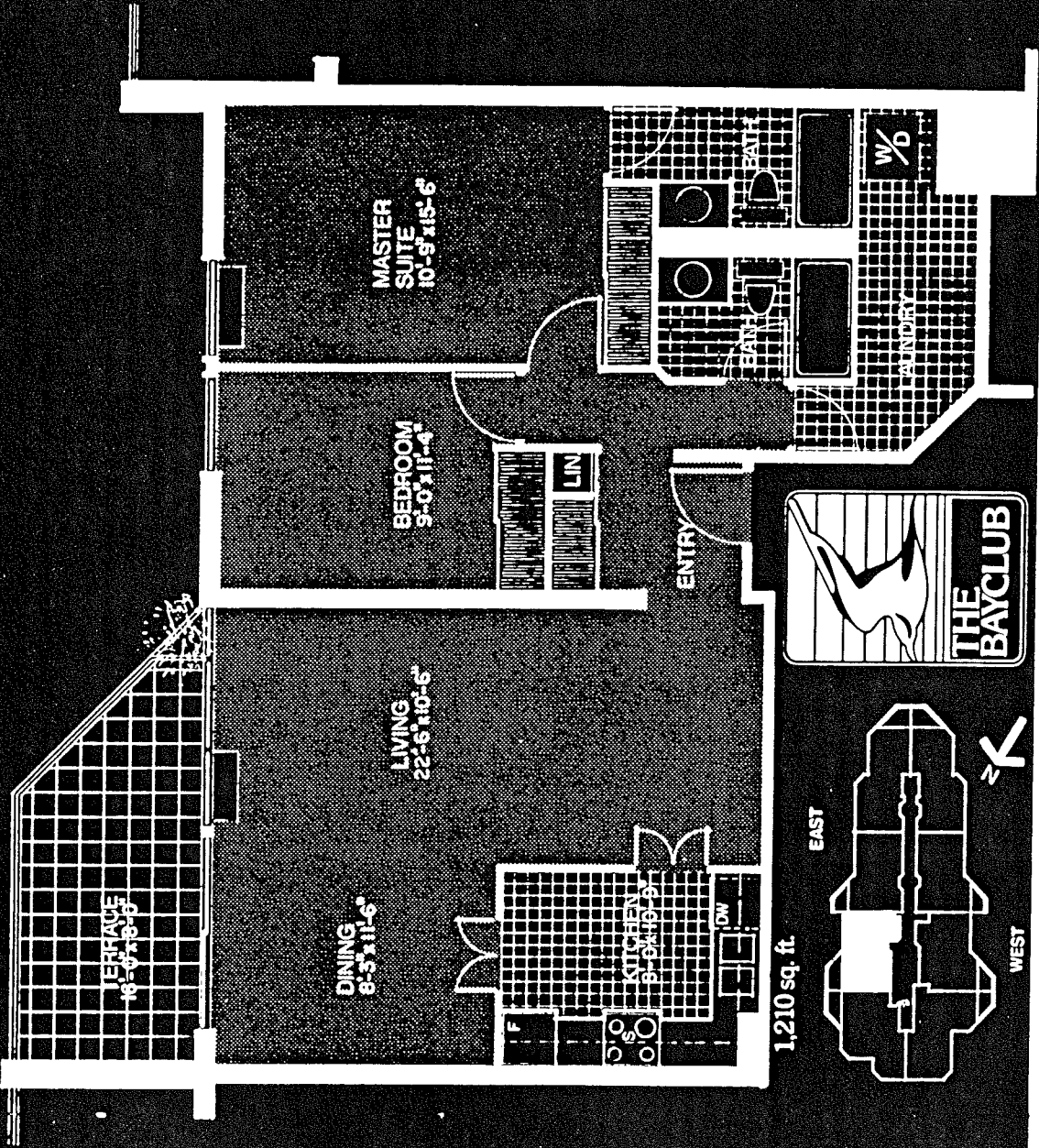

KILLDEER

An exciting departure from the ordinary. Notice the secluded bedroom area, the roominess of the master suite. The extra large entrance hallway allows for a study furniture grouping. Sunken living/dining area features a bay window looking south and west. An endless parade of sunsets will focus on your very private terrace.

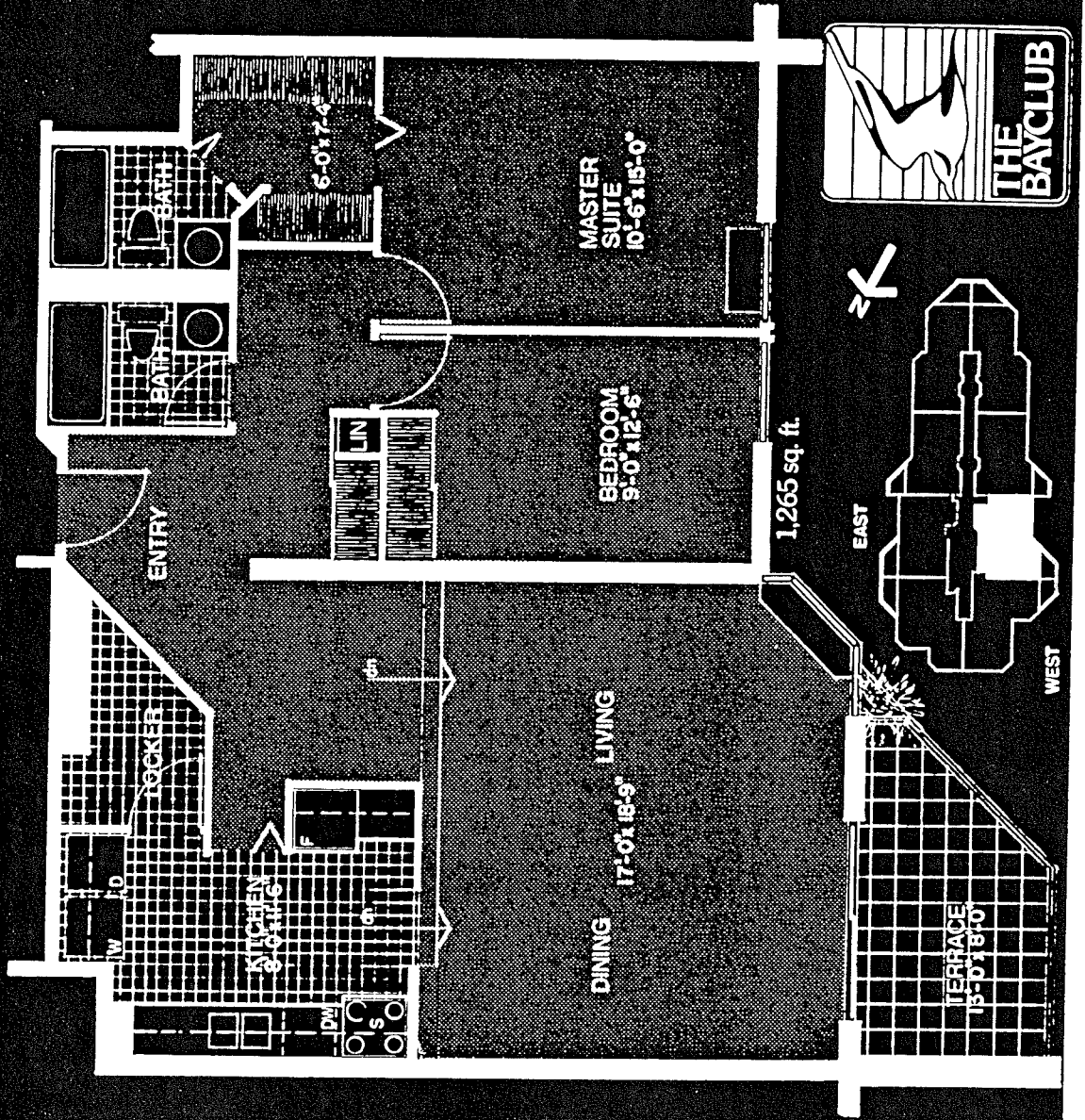

POUFFIN

A grand and dramatic foyer has all the space you need for a telephone desk and chair. The sunken living room and dining area with bay window commands an unobstructed sunrise or sunset view of Kempenfelt Bay. The room size terrace adds a new dimension to your spacious home.

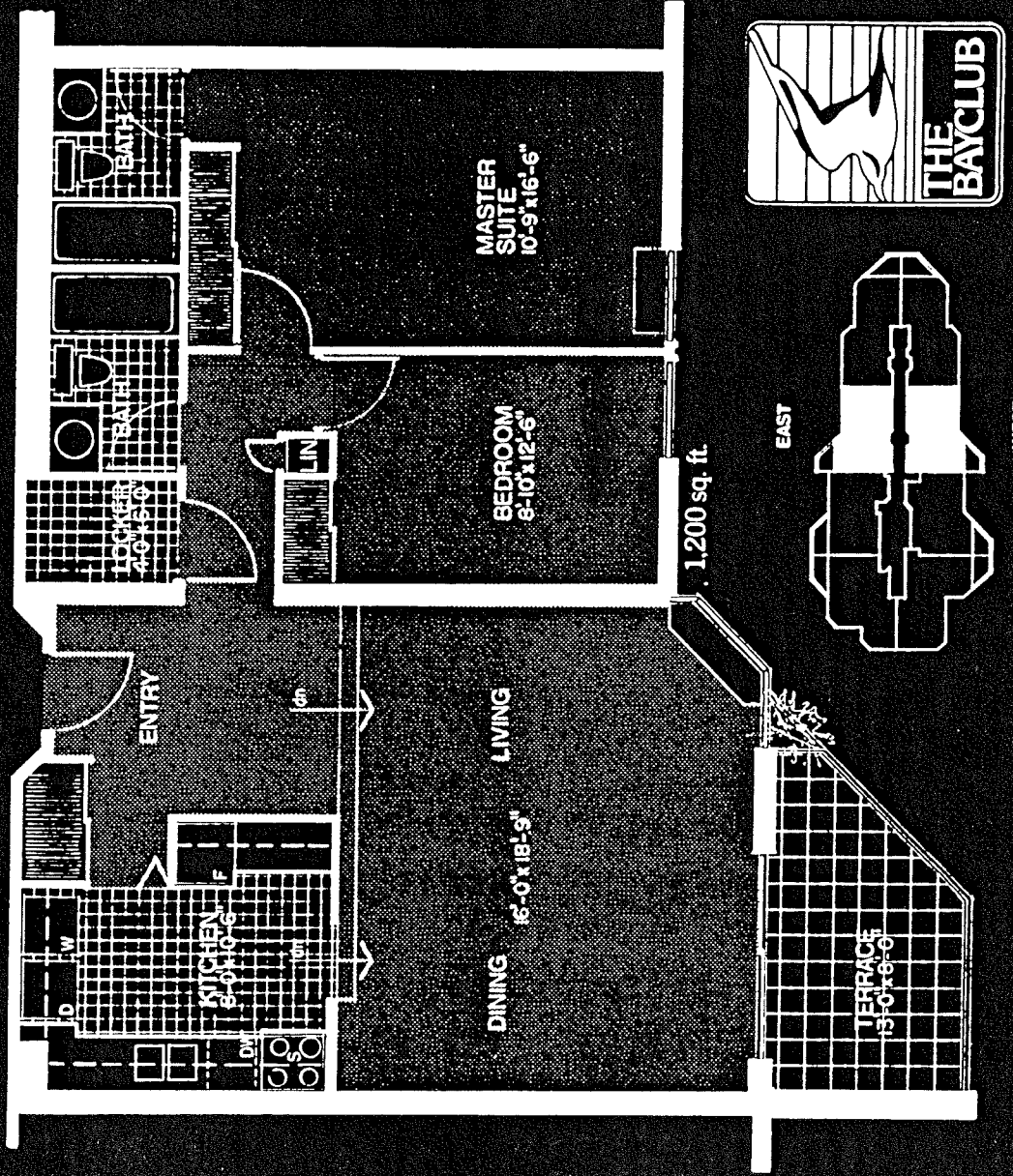

LOUNGE

A large dramatic entrance gallery leads to your retreat from the world or your hospitality centre depending on the mood. Master suite with dressing room and private bath. A tremendous feeling of openness as you step from the dining level down to the sunken living room which features a bay window. Optional study bedroom adds to your living space. As does the most spacious terrace providing a boundless vista over sunsets or sunsets on Kempenich Bay.

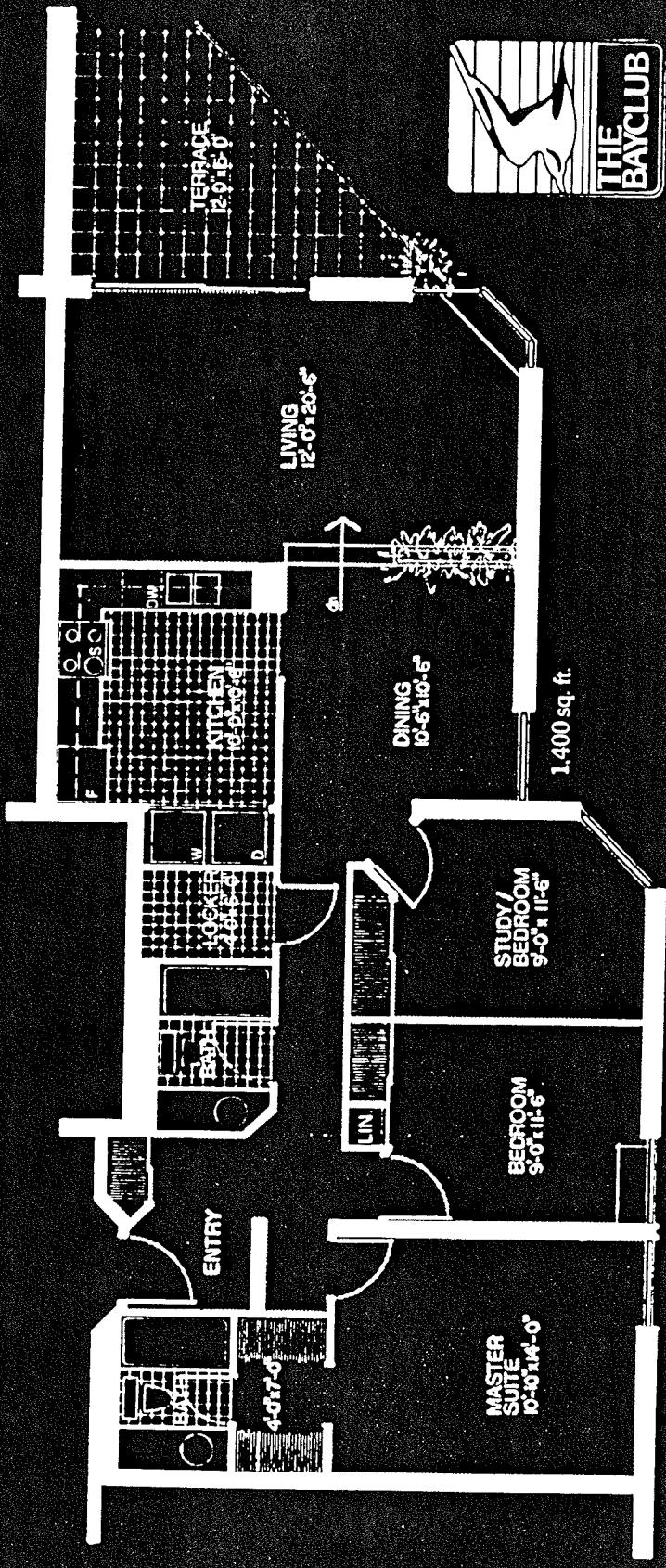

SOME OF THE OUTSTANDING FEATURES YOU'LL ENJOY AT THE BAYCLUB

Your membership in "The Club" at The Bayclub: complete health club facilities for your fitness programme plus hobby rooms and a social centre.

Exclusive indoor 20 ft. x 50 ft. heated swimming pool, indoor pool, adjoining large outdoor sun deck and Jacuzzi Therapeutic Whirlpool Bath.

Outdoor tennis court and two indoor squash courts for the improvement of your racquet skills.

Custom engineered high-speed Otis Elevators, planned for minimum waiting time. Spacious elevator lobbies on each floor.

Elegant natural brick hallway with recessed lighted entrance to your residence.

General Electric Zoneline Heating and Air conditioning System with individual temperature controls for maximum living comfort and economy through all seasons.

Maximum soundproofing and full fire protection provided by the solid reinforced concrete structure. Walls separating apartments are a minimum of 6" of solid prepared concrete—a first for Bay.

Bell Envelope System to residence from lobby with special security protection and the convenience of answering from any telephone extension.

Underground garage parking is provided on the basis of one assigned space to each residence. Garage has automated spinner system, self locking door, and a fully equipped car wash bay.

Convenient Motor Lounge with unloading zone to lobby directly from parking garage saving steps and driving time.

Emergency diesel power generator for public area lighting and elevator operation in the event of power failure.

Table tennis and games room.

Craft rooms for sewing, ceramics and oil painting.

Sunny painting room for plant enthusiasts.

Workshop with bench and lockers for your tools.

Social centre including library, cardroom and fully equipped kitchen is provided for club or private group activities.

Hotel suits for your guests on Club floor at a nominal charge.

Secure moving room with handy access to elevator.

Indoor bicycle storage room for your convenience.

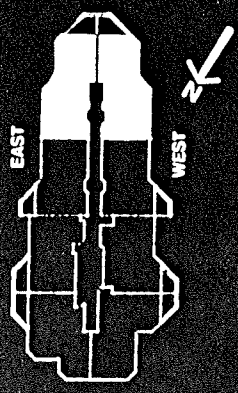

SANDPIPER GARDEN HOMES

Three spacious living levels, linked by a six ft. stairway. Collected dining room, sunken living room and spacious terrace provide an opportunity to enjoy the streetscape. Podium level entry, convenient powder room, step-saver kitchen and breakfast room complete the main floor. Back view master suite shares upper floor with two baths and two spacious bedrooms. Downstairs is linked to the parking garage. The Club and through the family room to the rear patio and garden. Entertaining will focus around the gracious wood burning fireplace.

2,050 sq. ft.

